

# ECC-RPU

## Remote Page Unit



### External Remote Console

## General

The ECC-RPU is an optional Remote Page Unit that is compatible with the ECC-50/100(E) Emergency Command Center for fire protection applications. It is part of the family of external remote consoles that allows for extending the ECC-50/100(E) display and control to remote locations within a building. It is housed in a cabinet with a keyed or an optional thumb lock to limit access to qualified personnel.

The ECC-RPU includes a built-in microphone and 8 selection buttons that can be pushed to activate the system remotely. ALL CALL paging can be broadcast over the speaker circuits by depressing the microphone's push-to talk button. As an added benefit, the 9th button on the RPU can be used to activate an MMF-300 monitor module that may be installed inside the ECC-RPU cabinet to be used for applications such as HVAC shutdown. The ECC-RPU requires an external data bus connection, an external audio riser connection, and an external operator interface power connection (24 Volts DC) from the ECC-50/100 main console.

### TYPICAL APPLICATIONS

- Schools
- Theaters
- Auditoriums
- Dormitories
- Healthcare Facilities
- Military Facilities
- Places of Worship
- Factories
- Restaurants
- Office Buildings

## Features

- Provides messaging status and control of the ECC-50/100(E) primary operator console.
- Modular design for maximum system flexibility and easy expansion.
- Supports both Class A (Style Z) and Class B (Style Y) wiring.
- A maximum of eight ECC-RPU's can be connected to an ECC-50/100(E) primary operating console.
- Built-in microphone with push-to-talk feature that can be used for ALL CALL paging.
- Up to fourteen programmable messaging functions that can be activated over speaker zones remotely.
- Sturdy cabinet design with a keyed lock to prevent unauthorized access. Optional thumb lock available.
- Simple and straightforward user interface.
- Additional 9th button can be used to activate an optional MMF-300 monitor module installed inside the cabinet for applications such as HVAC shutdown.

## Electrical Specifications

### PRIMARY POWER REQUIREMENTS:

**Voltage** 24VDC non-resettable power from the ECC-50/100(E). External Operator Interface Power (Non-supervised).

See ECC-50/100(E) Product Manual P/N LS10001-000FL-E for standby and alarm current requirements as well as battery calculations.

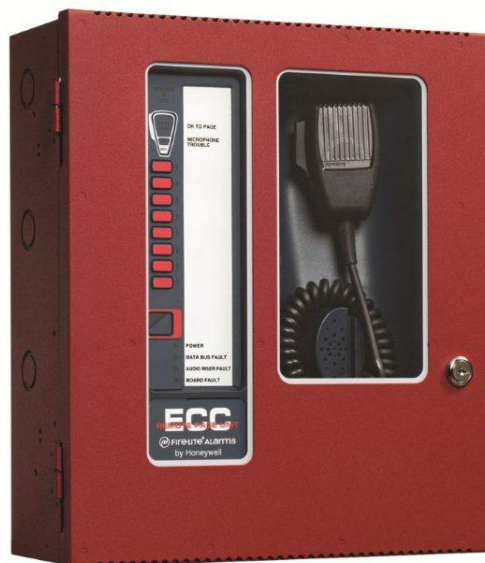

## Wiring Requirements

See Product Installation Document PN: LS10030-000FL-E for detailed wiring requirements.

## Optional Accessories

- **TR-6-R:** Trim ring for ECC-RPU (Red). 17.624"H x 16"W. (This provides a 1.5" wall coverage around the box).
- **MMF-300:** Monitor module used to supervise dry contact input devices.
- **THUMBLTCH:** Optional Thumb Latch. (Non UL Listed).

## Control and Indicators

### PUSH BUTTON CONTROLS

- All Call Button
- Message Select Buttons 1-14
- Microphone
- Push to talk switch
- Message Button 9

### LED STATUS INDICATORS (VISIBLE WITH DOOR CLOSED)

- System in Use (green)
- OK to Page (green)
- Mic Trouble (yellow)
- Message 1-8 Active (red)
- Message 1-8 Fault (yellow)
- Power (green)
- Data Bus Fault (yellow)
- Audio Riser Fault (yellow)
- Board Fault (yellow)

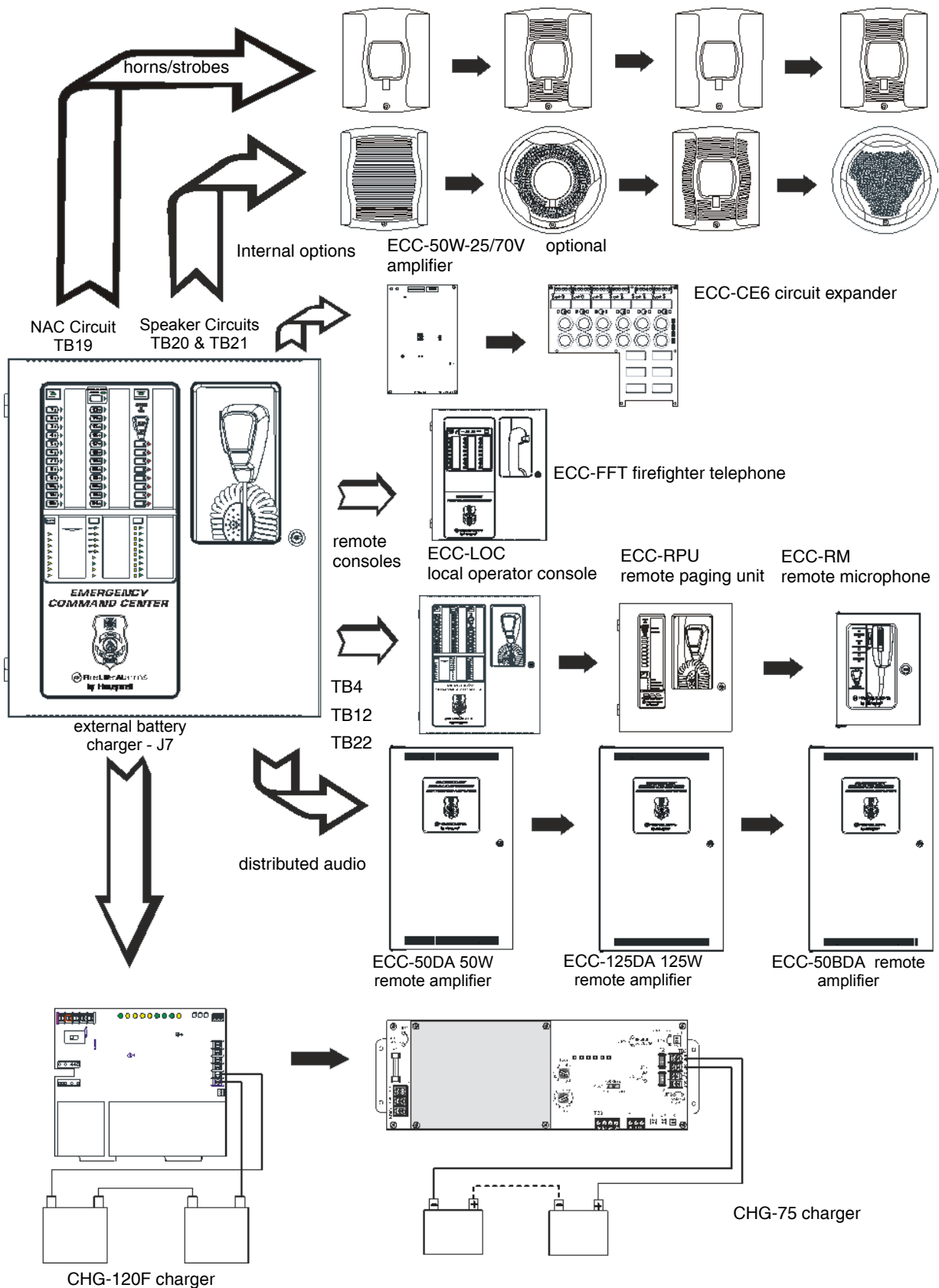

**ECC-50/100(E) Emergency Command Center (Possible Configurations)**

## Product Line Information (Ordering Information)

**ECC-RPU:** Remote Page Unit Hand held microphone, 14 message buttons.

**ECC-50/100:** (Primary operating Console) 50 Watt, 25VRMS single speaker zone emergency voice evacuation system, Integral microphone, built in tone generator and 14 recordable messages. *Please refer to the data sheet DF-60734 for more information.*

**ECC-50/100E:** Export version (Primary operating Console) 50 Watt, 25VRMS single speaker zone emergency voice evacuation system, Integral microphone, built in tone generator and 14 recordable messages, 240 VAC, 50 Hz. *Please refer to the data sheet DF-60734 for more information.*

**ECC-CE6:** Speaker Circuit/Zone Expander Module.

**ECC-50W-25V:** 25V, 50 watt audio amplifier module. Adding a second speaker circuit increases the total ECC-50/100 power output to 100 watts or can also be used as a backup amplifier.

**ECC-50W-70V:** 70V, 50 watt audio amplifier module. Adding a second speaker circuit increases the total ECC-50/100 power output to 100 watts or can also be used as a backup amplifier.

**ECC-XRM-70V:** 70V Transformer conversion module for 70V operation.

**ECC-LOC:** Local Operator Console (Complete user interface), *Please refer to the data sheet DF-60762 for more information.*

**ECC-RM:** Remote Microphone only. *Please refer to the data sheet DF-60760 for more information.*

**ECC-50DA:** Distributed (Remote) Audio Amplifier, 50 watts. *Please refer to the data sheet Please refer to the data sheet DF-60763 for more information.*

**ECC-50BDA:** Distributed (Remote) Audio Amplifier with backup, 50 watts/100 watts at 25Vrms or 70Vrms. *Please refer to the data sheet DF-60763 for more information.*

**ECC-50WBU:** Expander card for ECC-BDA remote amplifier for 100 watt primary/50 watt backup operation. *Please refer to the data sheet DF-60763 for more information.*

**ECC-125DA:** Distributed (Remote) Audio Amplifier, 125 watts. *Please refer to the data sheet DF-60763 for more information.*

**ECC-50DAE:** Export version. Distributed (Remote) Audio Amplifier, 50 watts, 240 VAC, 50 Hz. *Please refer to the data sheet DF-60763 for more information.*

**ECC-125DAE:** Export version. Distributed (Remote) Audio Amplifier, 125 watts, 240 VAC, 50 Hz. *Please refer to the data sheet DF-60763 for more information.*

**ECC-CE4:** Distributed Audio Speaker Circuit/Zone expander module.

**ECC-FFT:** Fire Fighter Telephone System. *Please refer to the data sheet DF-60765 for more information.*

**FPJ-F:** Remote Phone Jack.

**FHS-F:** Fire Fighters Remote Handset.

**FHSC-RF:** Fire Fighters Handset Cabinet Recessed.

**FHSC-SF:** Fire Fighters Handset Cabinet Surface Mount.

**MMF-301:** Addressable Mini-Monitor Module.

**I300:** SLC Line Isolation Module.

**ECC-MICROPHONE:** Replacement microphone only.

**TR-CE:** Optional Trim Ring. 17.624" high (44.77 cm) x 16.0" wide (40.64 cm).

**THUMBLTCH:** Optional Thumb Latch. (Non UL Listed).

**CHG-75:** 25 to 75 ampere-hours (AH) external battery charger.

**CHG-120F:** 25-120 ampere-hours (AH) external battery charger.

**BAT-1270:** Battery, 12volt, 7.0AH (Two required).

**BAT-12120:** Battery, 12volt, 12.0AH (Two required).

**BAT-12180:** Battery, 12volt, 18.0AH (Two required).

**BB-26:** Battery back box – Mounts up to 2, BAT-12260 Batteries.

**BB-55F:** Battery Box -- Mounts up to 2, BAT-12260 or BAT-12550s.

**TR-RPU:** Trim ring used semi-flush mount installations.

**TR-6-R:** Trim ring.

**MMF-300:** Monitor module used to supervise dry contact input devices.

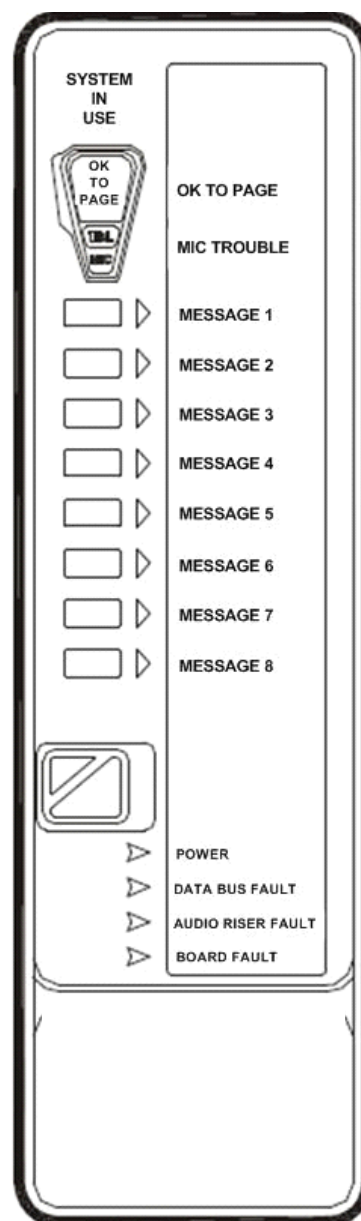

## Temperature and Humidity ranges

This system meets NFPA requirements for operation at 0-49° C/32-120° F and at a relative humidity 93% ± 2% RH (non-condensing) at 32°C ± 2°C (90°F ± 3°F). However, the useful

life of the system's standby batteries and the electronic components may be adversely affected by extreme temperature ranges and humidity. Therefore, it is recommended that this system and its peripherals be installed in an environment with a normal room temperature of 15-27° C/60-80° F.

### **Cabinet Specifications**

**ECC-RPU:** 14.50" (36.8 cm) high x 12.875" (32.70 cm) wide x 4.534" (11.52 cm) deep. (Door attached and closed).

**TR-RPU:** Trim ring for ECC-RPU (Red). 17.624"H x 16"W. (This provides a 1.5" wall coverage around the box).

### **Shipping Specifications**

Weight: 11.6 lbs (5.27 kg).

### **Agency Listings and Approvals**

The listings and approvals below apply to the basic ECC-50/100(E) Fire emergency voice evacuation system. In some cases, certain modules may not be listed by certain approval agencies or listing may be in process. Consult factory for latest listing status.

UL Listed S2424.

CSFM: 7300-0075:0227.

FDNY: COA #6152.

FM Approved.

### **Standards and Codes**

The ECC-RPU complies with the following UL Standards and with NFPA 72 Fire Alarm system requirements.

UL 864.

©2014 by Fire•Lite Alarms. All rights reserved. Unauthorized use of this document is strictly prohibited.



This document is not intended to be used for installation purposes.  
We try to keep our product information up-to-date and accurate.  
We cannot cover all specific applications or anticipate all requirements.  
All specifications are subject to change without notice.



For more information, contact Fire•Lite Alarms. Phone: (800) 627-3473, FAX: (877) 699-4105.  
[www.firelite.com](http://www.firelite.com)